

MAX FINISHED MATERIAL
FRAME COVERAGE: 1/4"

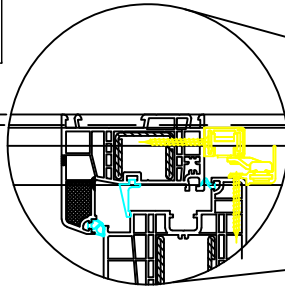

**DO NOT COVER MORE THAN 1/4" OF THE
FRAME AT THE TOP**

**DO NOT COVER MORE THAN 1/2" OF THE
FRAME AT THE SIDES**

**DO NOT USE FLOOR FINISH
THICKER THAN 3/4"**

MAX FINISHED MATERIAL
FRAME COVERAGE: 1/2"

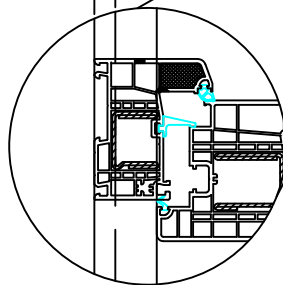

MAX FINISHED MATERIAL
FRAME COVERAGE: 3/4"

